



PRODUCT NAME: Jessie Table Lamp

ITEM NUMBER: LA371

ASSEMBLED DIMENSIONS: 27"H x 14" Diameter

Shade Dimensions: 9"H x 14" Diameter

Base Dimensions: 16"H x 6.5" Diameter (Bottom)  
4.5" Diameter (Top)

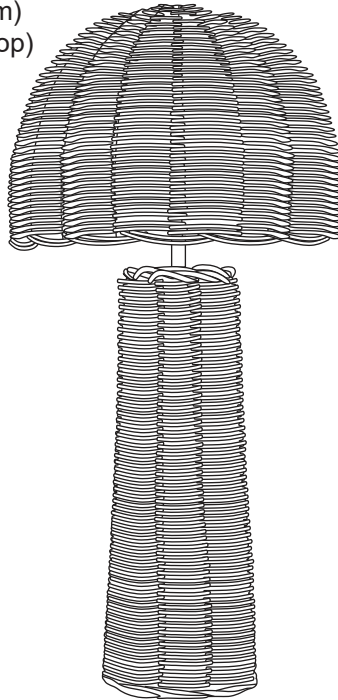

## IMPORTANT SAFETY INSTRUCTIONS:

- This Lamp has a polarized plug (one blade is wider than the other) as a feature to reduce the risk of electric shock. This plug will fit one way into a Polarized Outlet. If the plug does not fully fit into the outlet, reverse the plug. If it still does not fit, contact a qualified electrician. Never use with an extension cord unless plug can be fully inserted. Do not alter the plug.
- For your safety, please read instructions carefully and completely before beginning assembly or installation.
- Product must be installed according to applicable code(s) by a person familiar with its construction and operation.
- This Lamp rated up to 100 Watt MAX Type A Bulb (Not Included). \*LED recommended.



## WARNING:

- Deviation from assembly instructions may cause risk of fire or electric shock.
- To reduce risk of personal injury, always turn off lamp and allow bulbs to cool prior to replacement.
- Do not touch or look directly at illuminated bulbs.
- Keep flammable material away from illuminated bulbs.



Unplug lamp prior to installation or removal.

Remove all parts, hardware and protective packaging from carton and carefully arrange on a clean, level surface.

**NOTE:** To avoid accidentally discarding small parts or hardware, retain all carton contents until after assembly and installation are complete.

**Approved Location for Use:** Dry Indoor Environment

**Assembly Time:** 5 Minutes

**Assembled Weight:** 7.8 lbs.

Lamp Body (A)

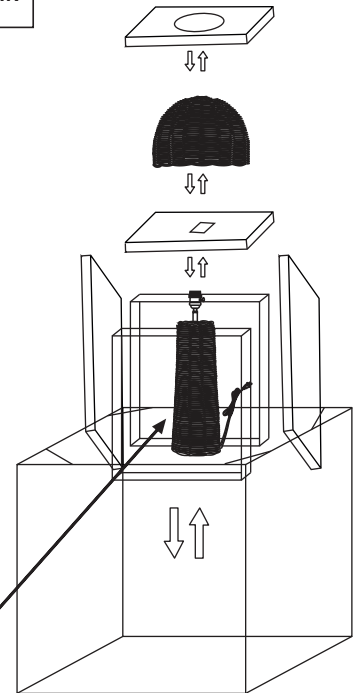

## HARDWARE AND COMPONENTS

**INCLUDED:** Lamp Body, Shade and Socket Ring (may be attached to socket)

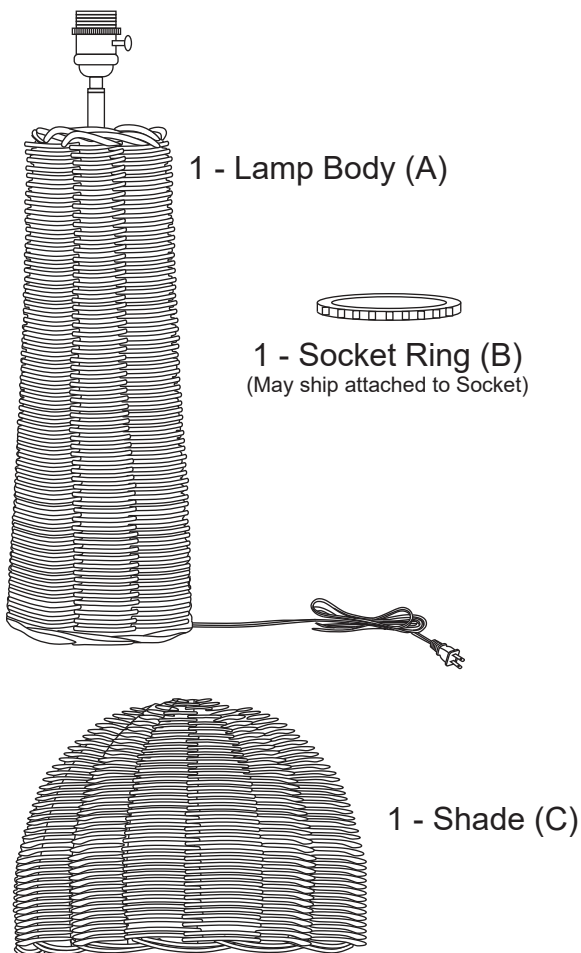

### NOT INCLUDED:

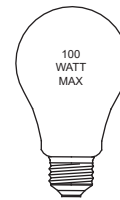

1 - 100 Watt Max  
Type A Bulb  
LED Recommended



### WARNING FIRE HAZARD

UL Standard requires shade to be open on both top and bottom.

**Critical Radius** is distance between bulb center and side of shade. For this lamp it should NOT be less than 3"

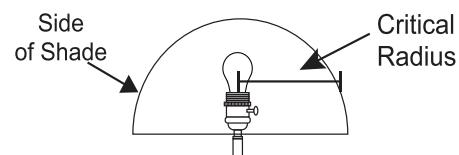

### Cleaning and Care

Periodically wipe Lamp with a soft, dry cloth or vacuum with a soft brush attachment.  
Do not use liquid cleaners. Discoloration may result.



Customer Service: 800-367-2810  
Online: [www.ballarddesigns.com](http://www.ballarddesigns.com)



Unplug lamp prior to installation or removal.

### STEP 1: REMOVE SOCKET RING

Ring (B) typically ships attached to lamp socket. Gently turn counterclockwise and remove from socket.

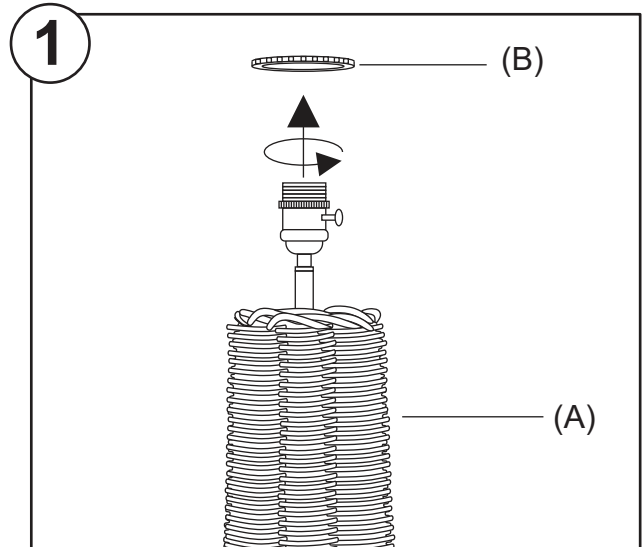

### STEP 2: INSTALL SHADE

Carefully fit ring-fitter on Shade (C) over lamp socket. Next, replace SOCKET RING by turning clockwise onto lamp socket. Turn until Shade is secured.

**CAUTION: Do not over-tighten ring.**

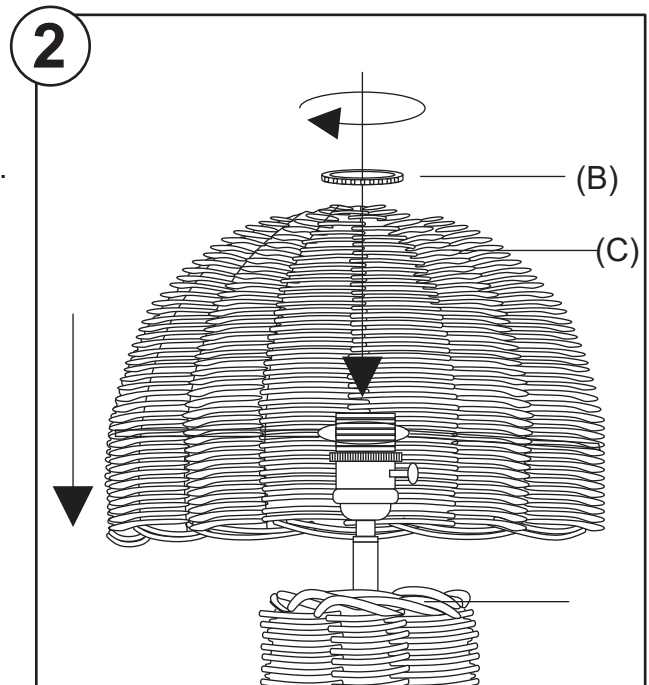

### STEP 3: INSTALL BULB

Carefully turn bulb (not included) into lamp socket.

**NOTICE:** Socket is rated up to a 100 watt bulb. LED is recommended for longer bulb life and less heat. To mimic the color of an incandescent bulb, choose 2700K warm or soft white.

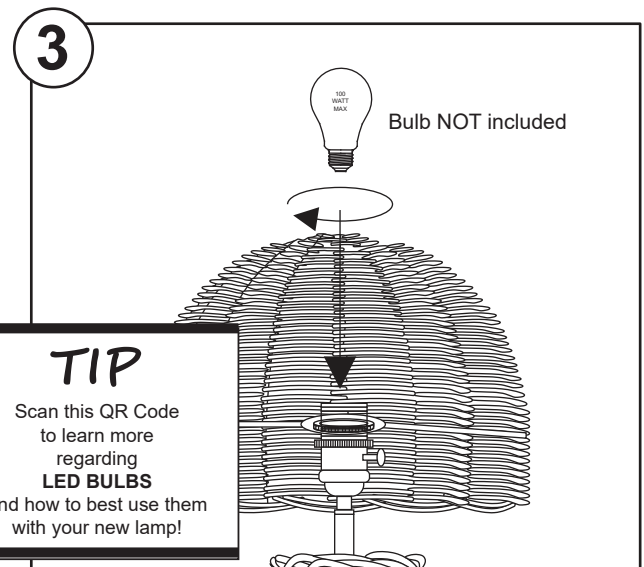

Customer Service: 800-367-2810  
Online: [www.ballarddesigns.com](http://www.ballarddesigns.com)



### TIP

Scan this QR Code to learn more regarding **LED BULBS** and how to best use them with your new lamp!